

KEYBOARD & MOUSE MOUNT

Assembly Guide

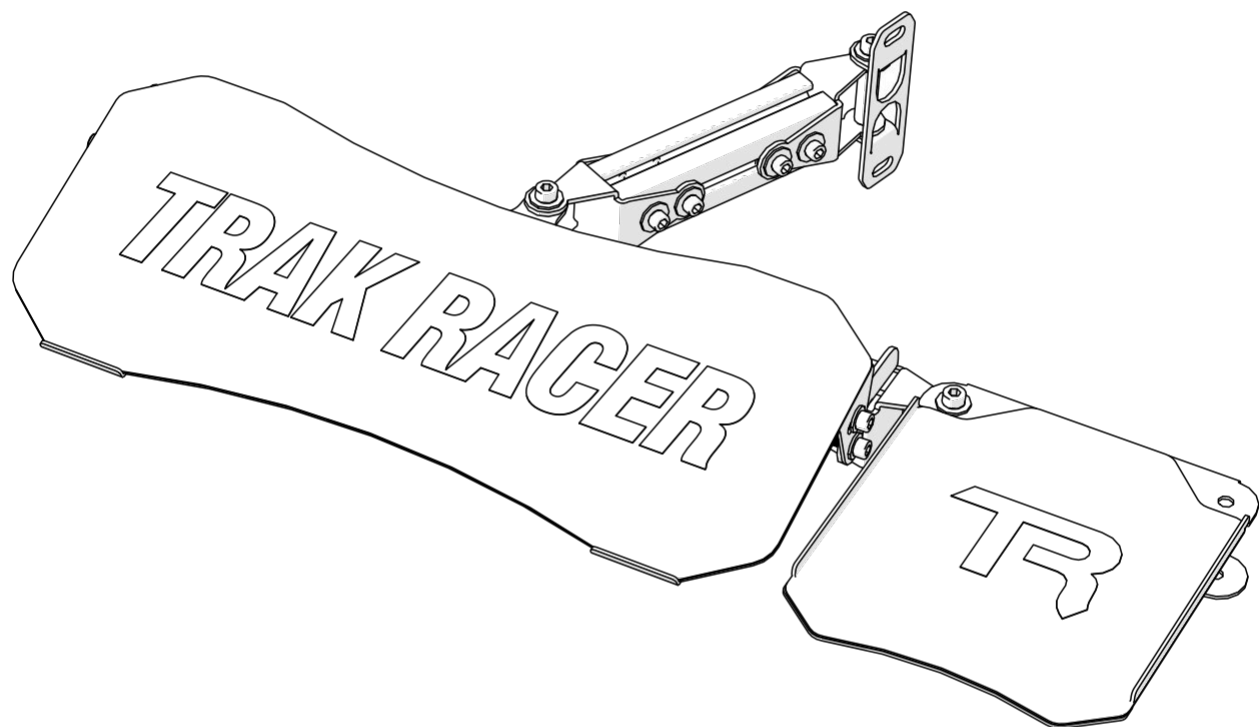

IMPORTANT: Different regions may have different models. Please ensure the part number below matches that on your product's box.

TR80-KBMMS



TRAK RACER

Published Apr 1, 2025

TABLE OF CONTENTS

3 Symbol Legend

4 Part List

5 Assembly Notes

7 Assembly Instructions



IMPORTANT: Since there are different versions of each product based on your region, please make sure you are using the correct set of instructions. The part number below should match the one on your box.



IMPORTANT: Due to the nature of cut aluminum profiles, some metal shavings may remain despite our thorough QA cleaning process. We recommend opening boxes and packaging on a hard surface.



NOTE: Some screws and washers may be pre-installed. These are included in the parts list and will need to be loosened and reattached according to the instructions.



Recommended: Two people for the task



Tighten the hardware



Keep the hardware loose for adjustments



Make the necessary adjustments



Break the tab off the corner bracket



Safety glasses required



Attention/Priority needed



Reserve for the next step



Mirrored components (same on both sides)

PART LISTS

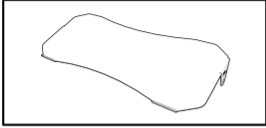

Keyboard Mount Plate
KBMMS-1 x1

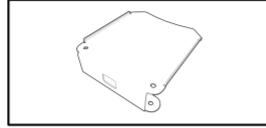

Mouse Mount Plate
KBMMS-2 x1

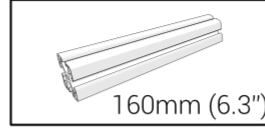

Aluminum Profile
TR-4040-160 x1

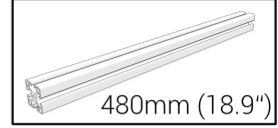

Aluminum Profile
TR-4040-480 x1

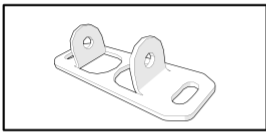

Fixed Adjustment Plate
FAP x1

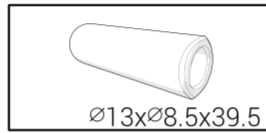

Short Fixed Rod
SFR-39.5 x1

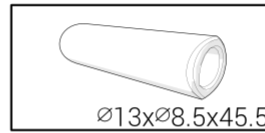

Short Fixed Rod
SFR-45.5 x2



Keyboard Pad
KP-1 x1

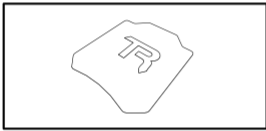

Mouse Pad
MP-1 x1

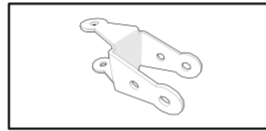

Corner Support-1
CS-1 x3

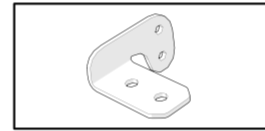

Corner Support-2
CS-2 x2

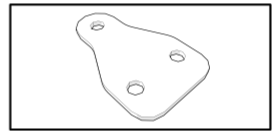

Fixing Plate
FP-1 x1

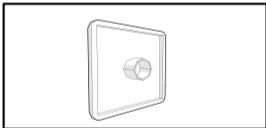

End Cap, 40x40
EC-40 x1

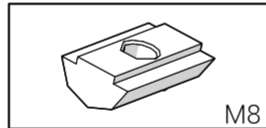

Ball Bearing Nut
NS-M8 x10

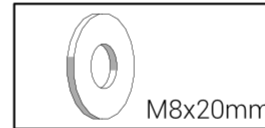

Washer (Flat)
WF-M8-20 x12

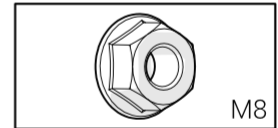

Flange Nut
NF-M8 x7

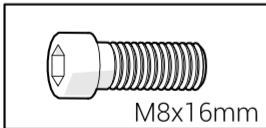

Screw (Hex)
SH-M8-16 x10

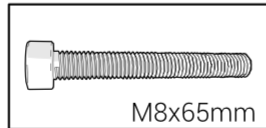

Screw (Hex)
SH-M8-65 x2

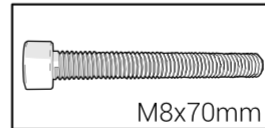

Screw (Hex)
SH-M8-70 x1

NOTE

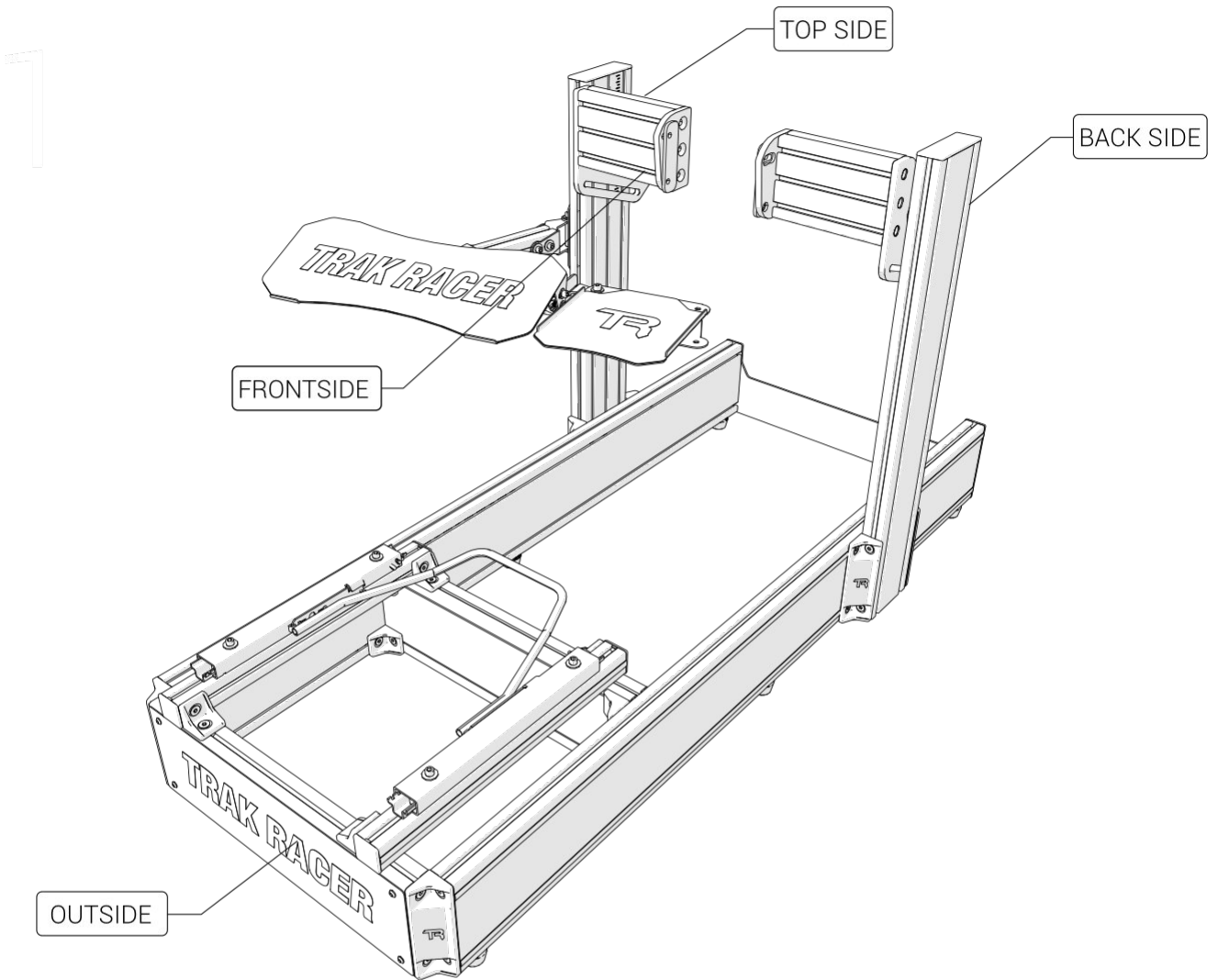

INSTALLATION ORDER FOR SCREWS & WASHERS

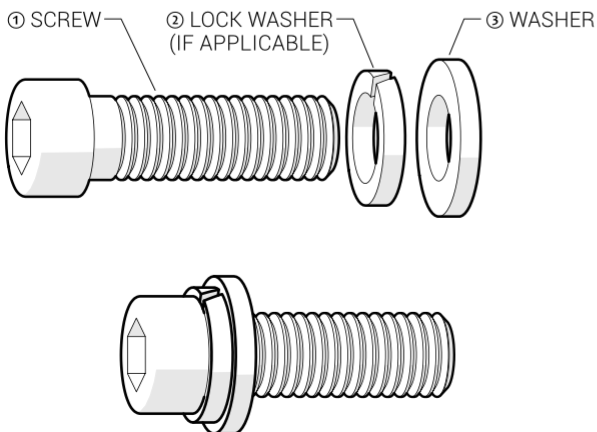

HOW TO MEASURE SCREWS

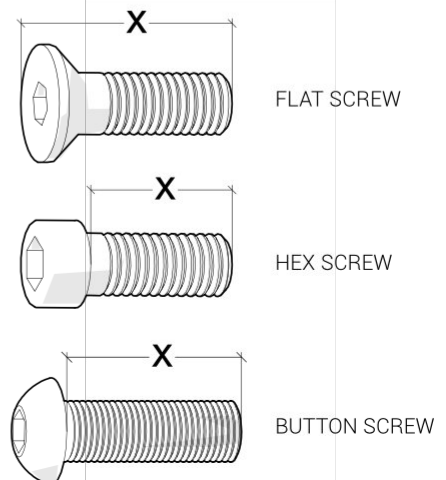

NOTE

NS-M8 & NS-M6

Slide T-Nuts into the ends of the profiles. Some must be added early, so follow the steps in this manual carefully.

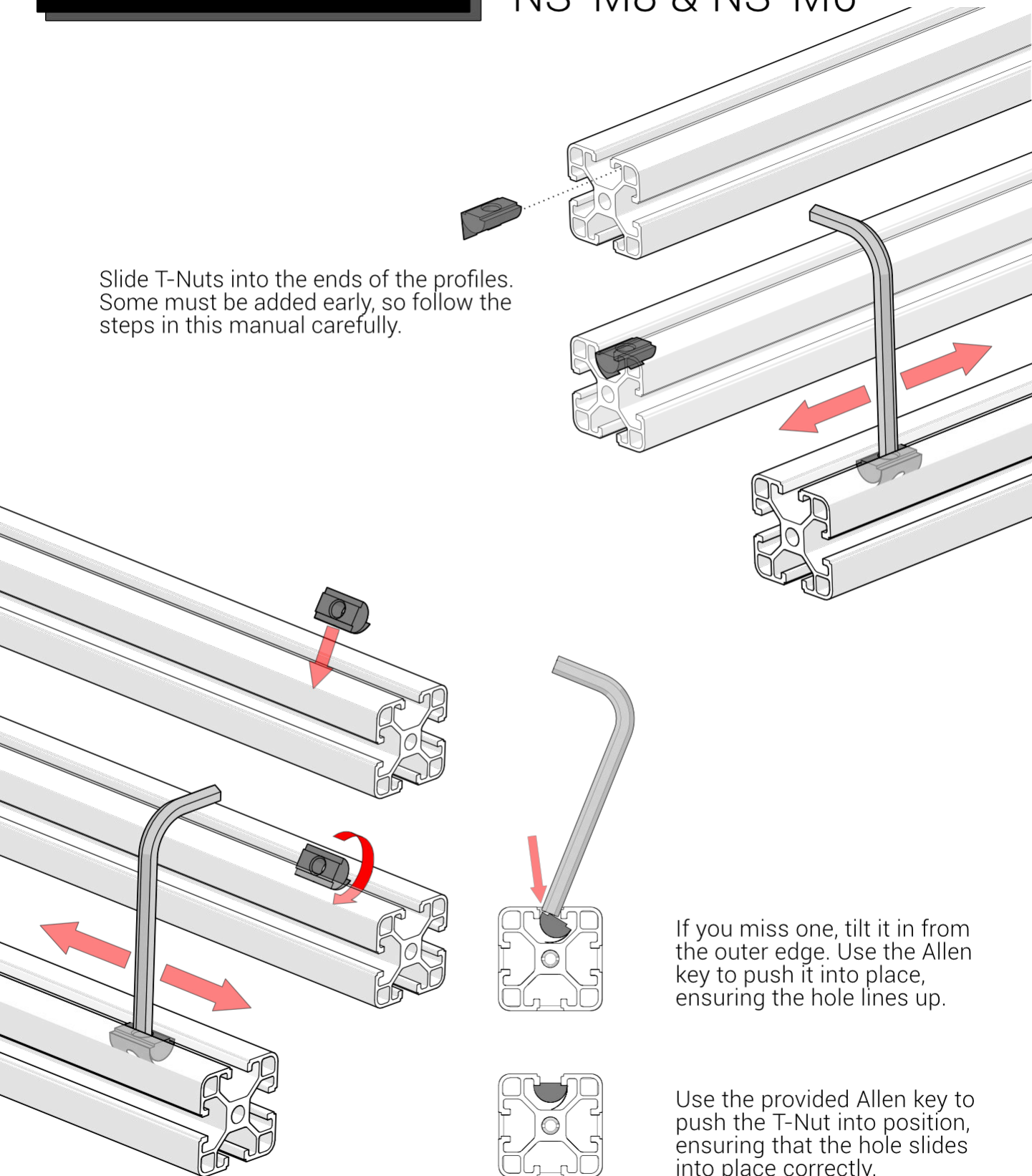

1

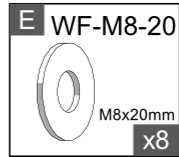
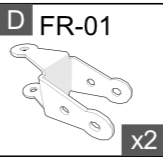
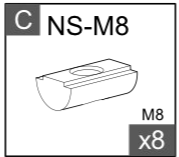
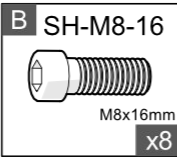
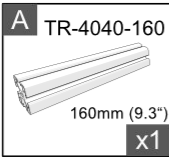

Pre-assembled for
Your convenience

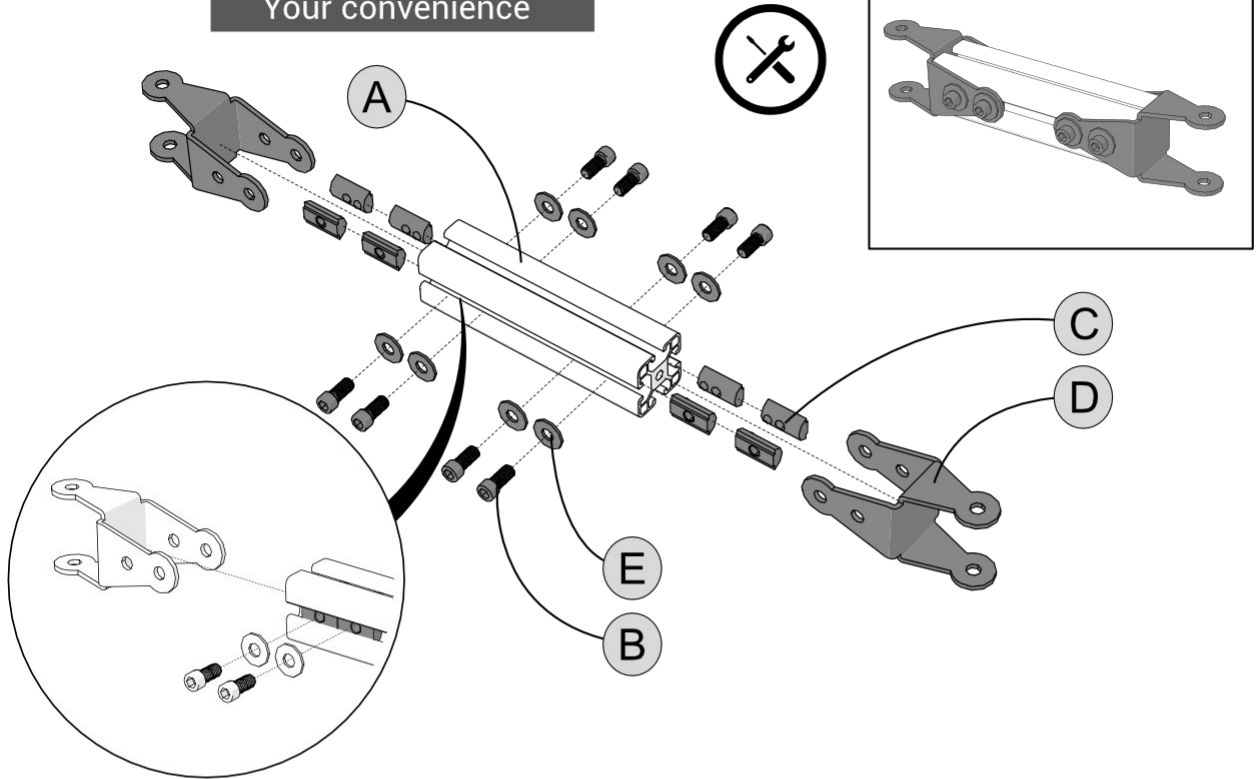



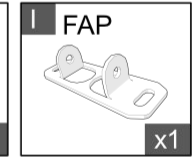
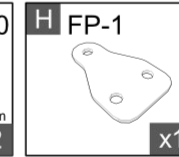
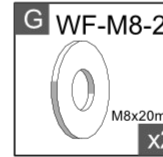
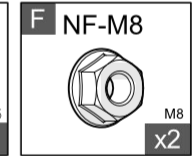
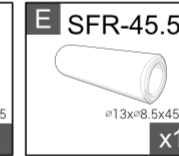
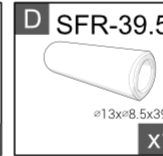
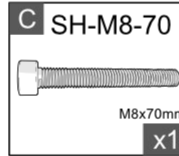
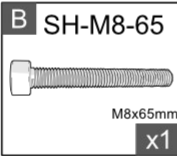
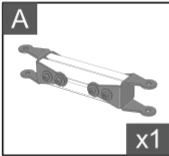

2

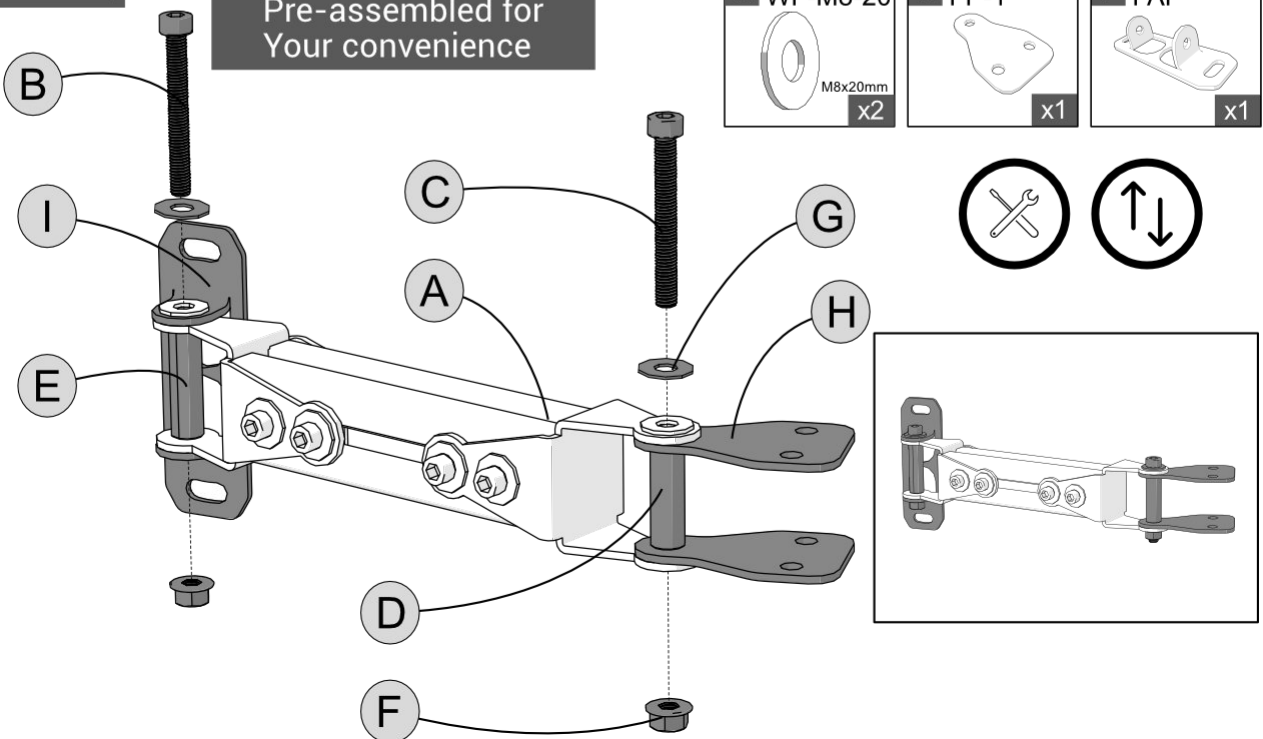

Pre-assembled for
Your convenience

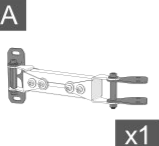

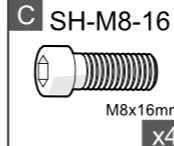
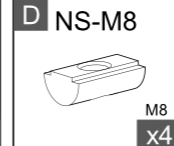

3

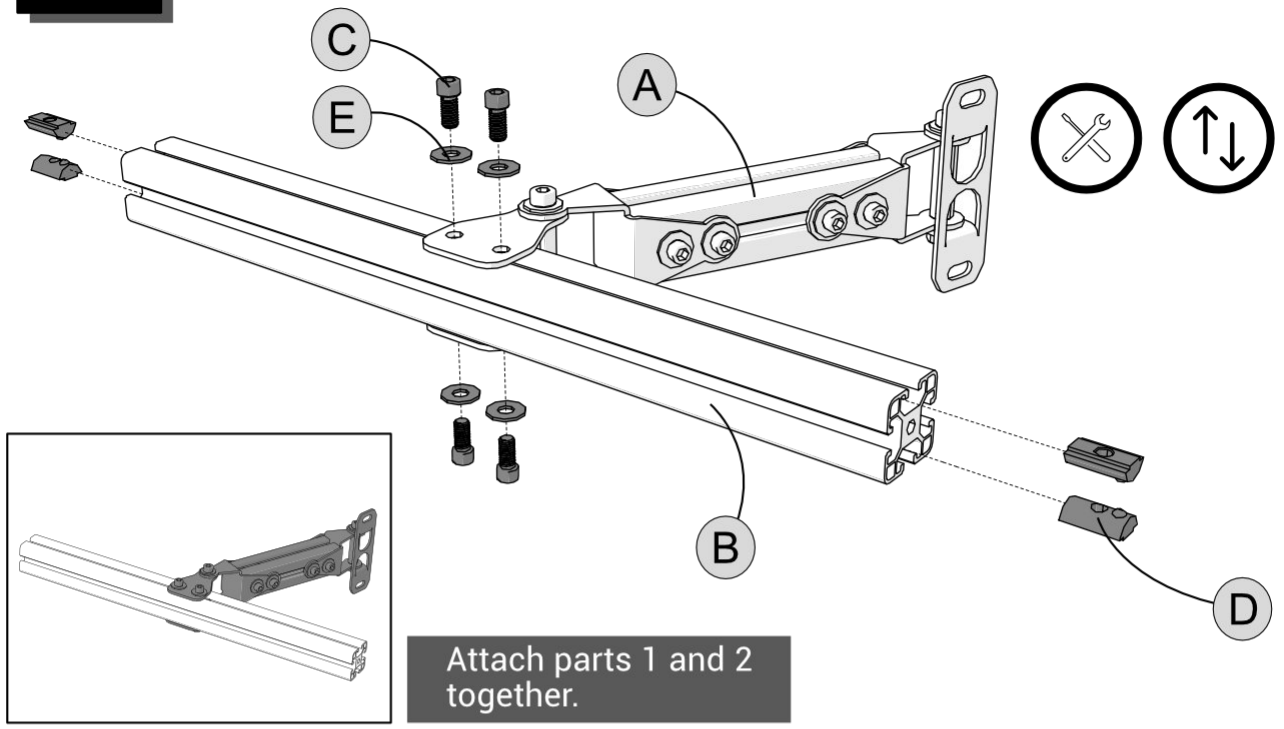
- A**

 x1
- B** TR-4040-480

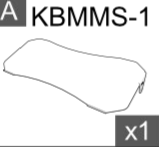
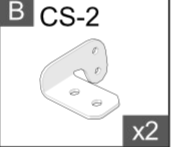
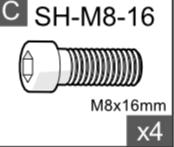
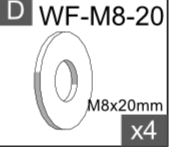
 480mm (18.9")
 x1
- C** SH-M8-16

 M8x16mm
 x4
- D** NS-M8

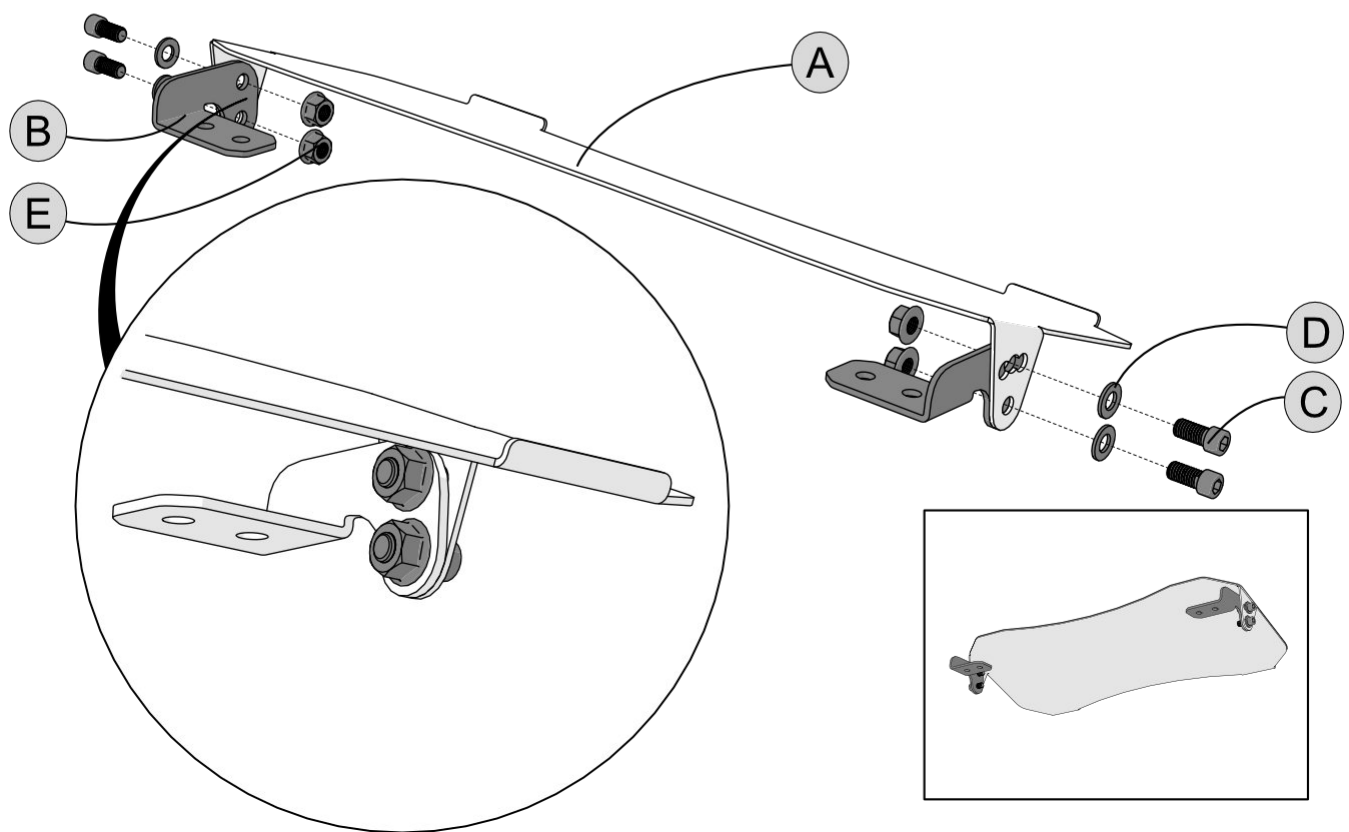
 M8
 x4
- E** WF-M8-20

 M8x20mm
 x4



4

- A** KBMMS-1

 x1
- B** CS-2

 x2
- C** SH-M8-16

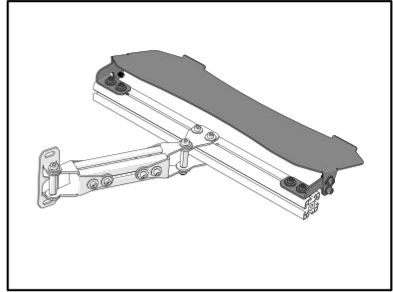
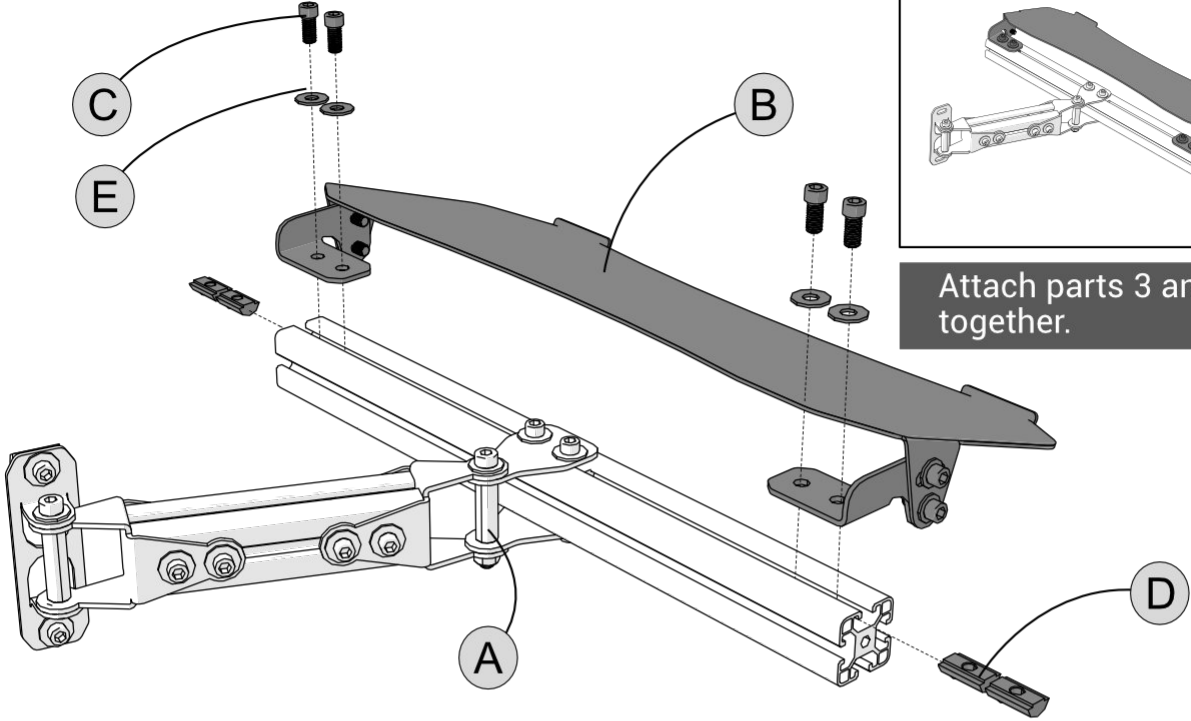
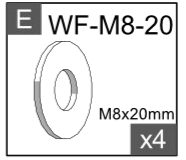
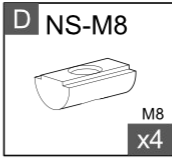
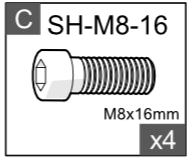
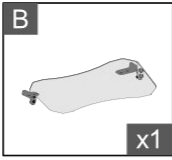
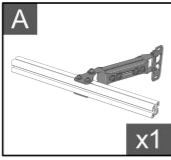
 M8x16mm
 x4
- D** WF-M8-20

 M8x20mm
 x4
- E** NF-M8

 M8
 x4



5



Attach parts 3 and 4 together.

6

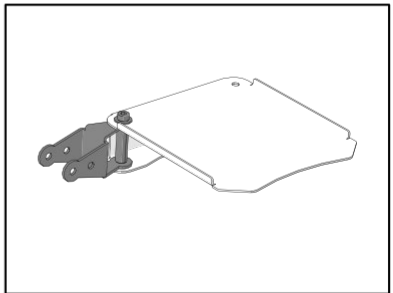
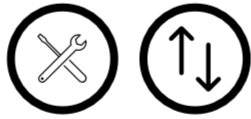
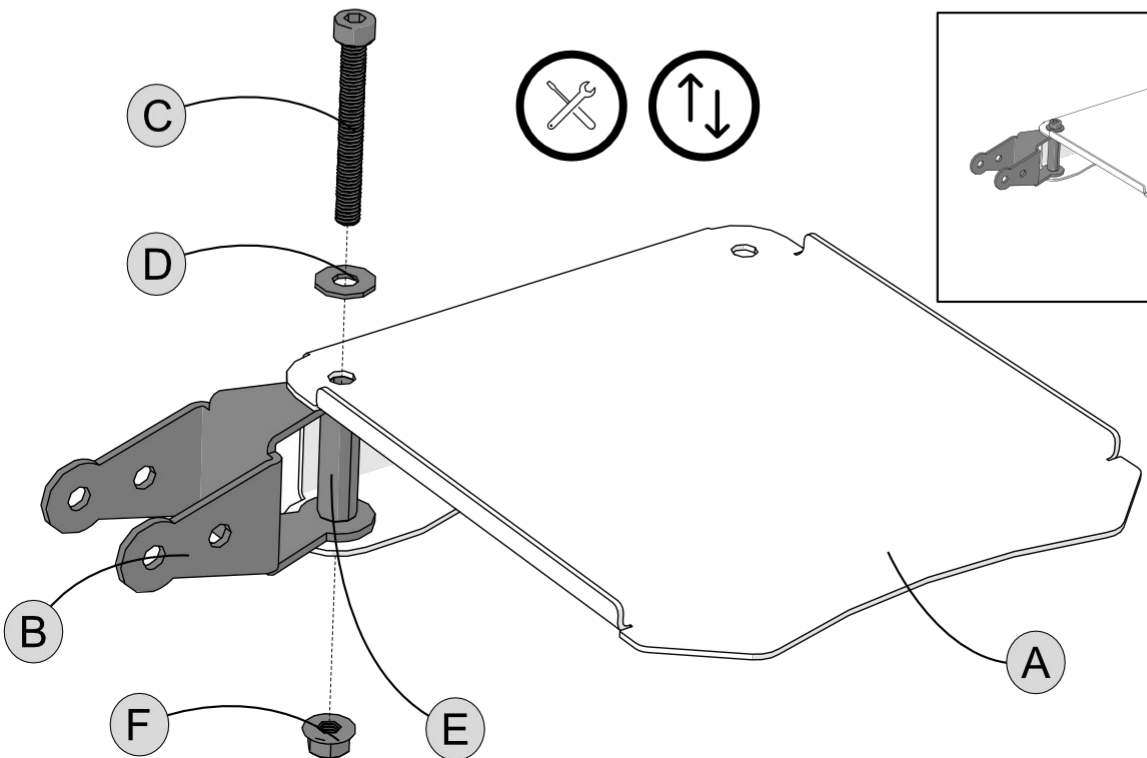
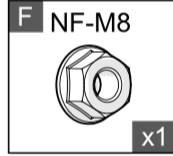
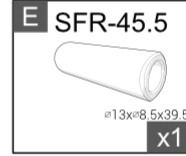
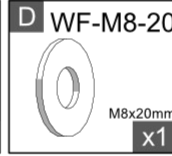
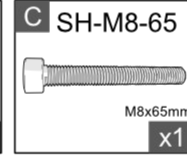
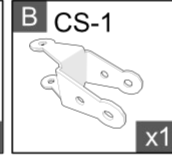
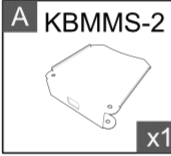

7

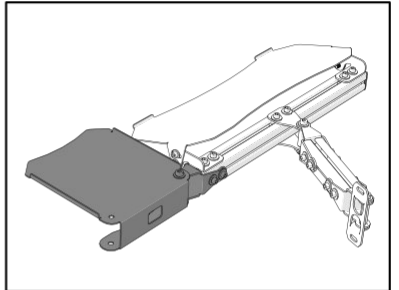
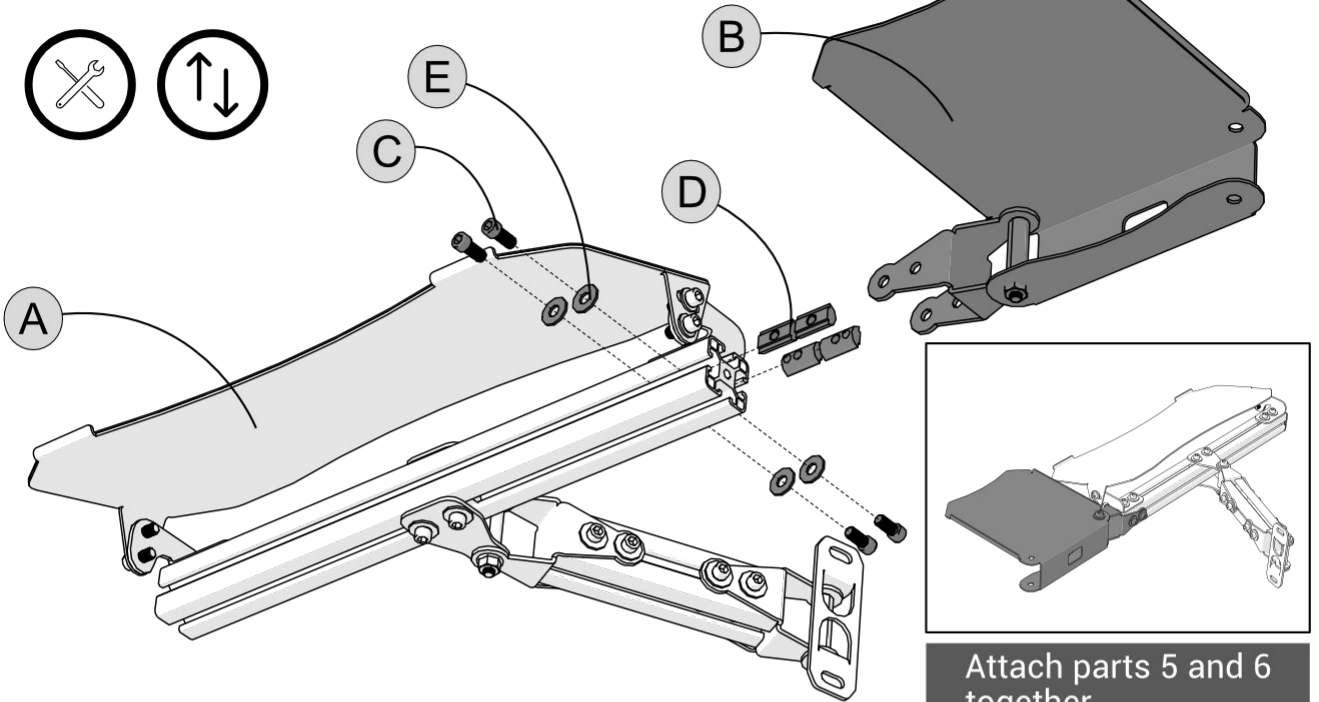
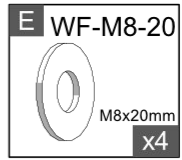
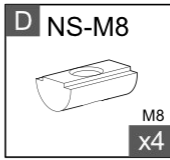
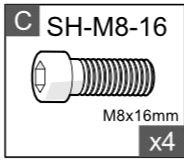
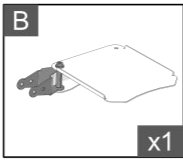
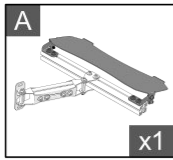

Attach parts 5 and 6 together.

8

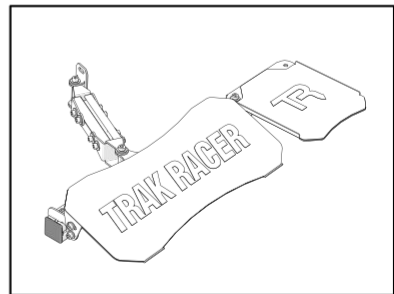
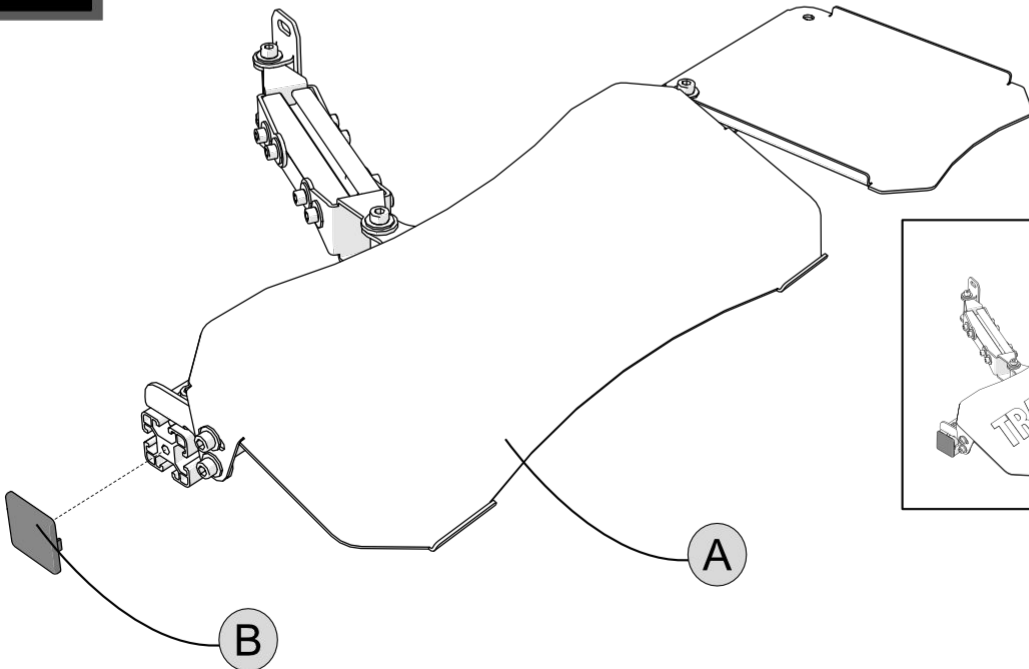
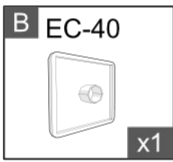
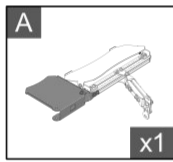

9

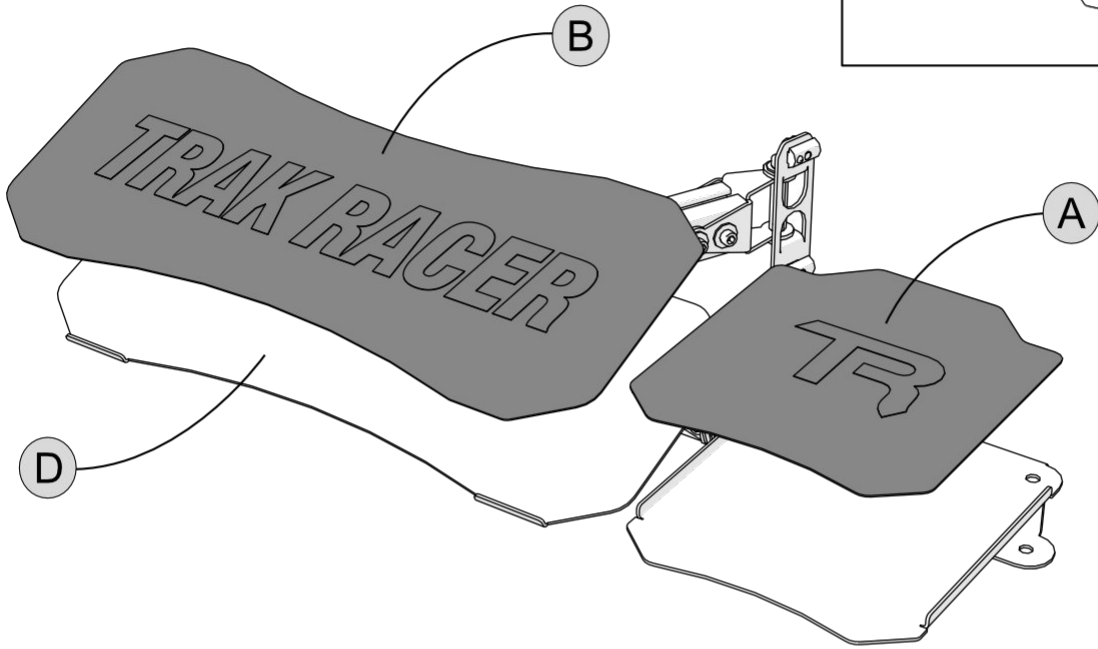
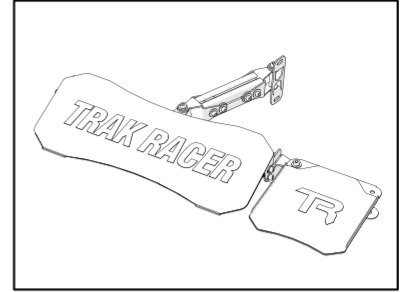
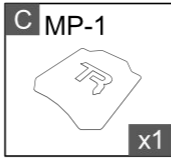
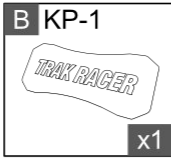
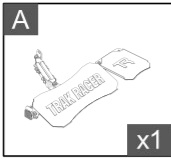

10

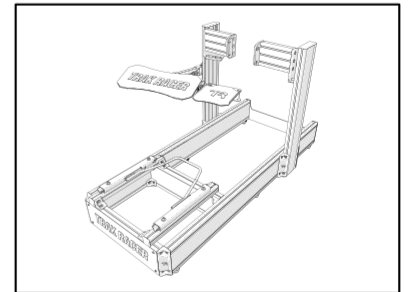
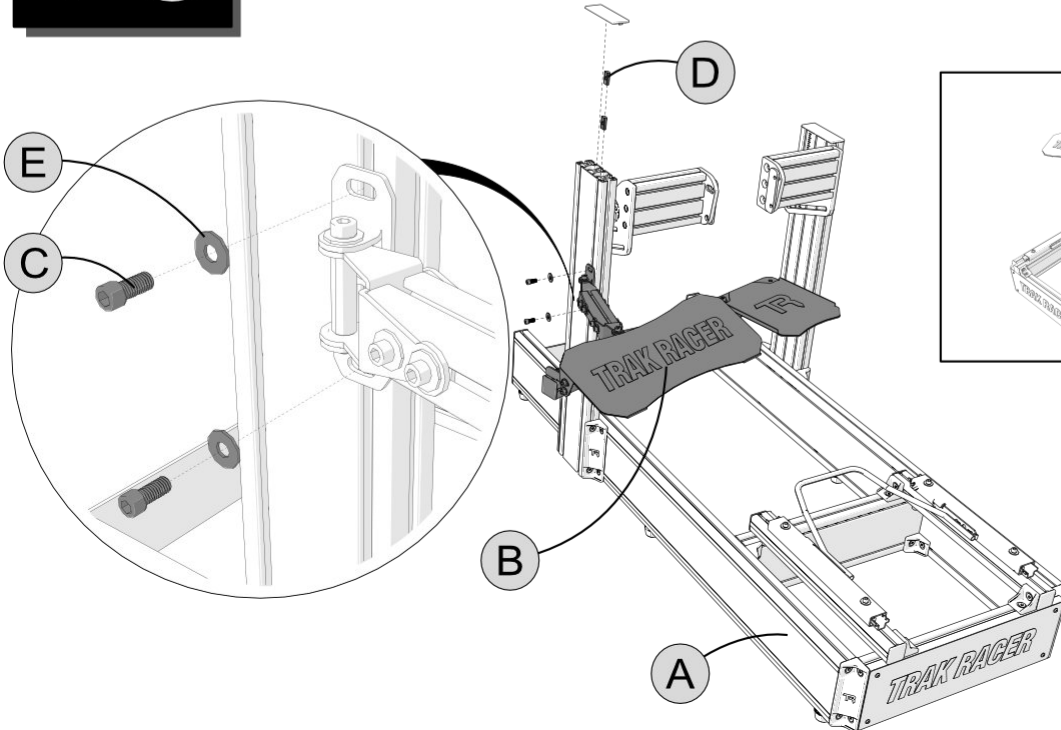
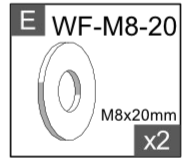
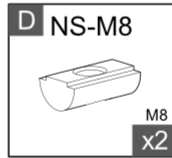
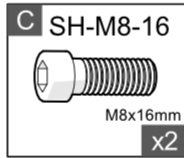
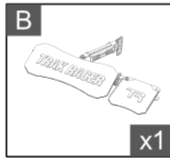
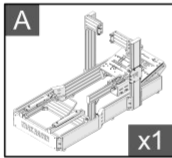

FINISHED

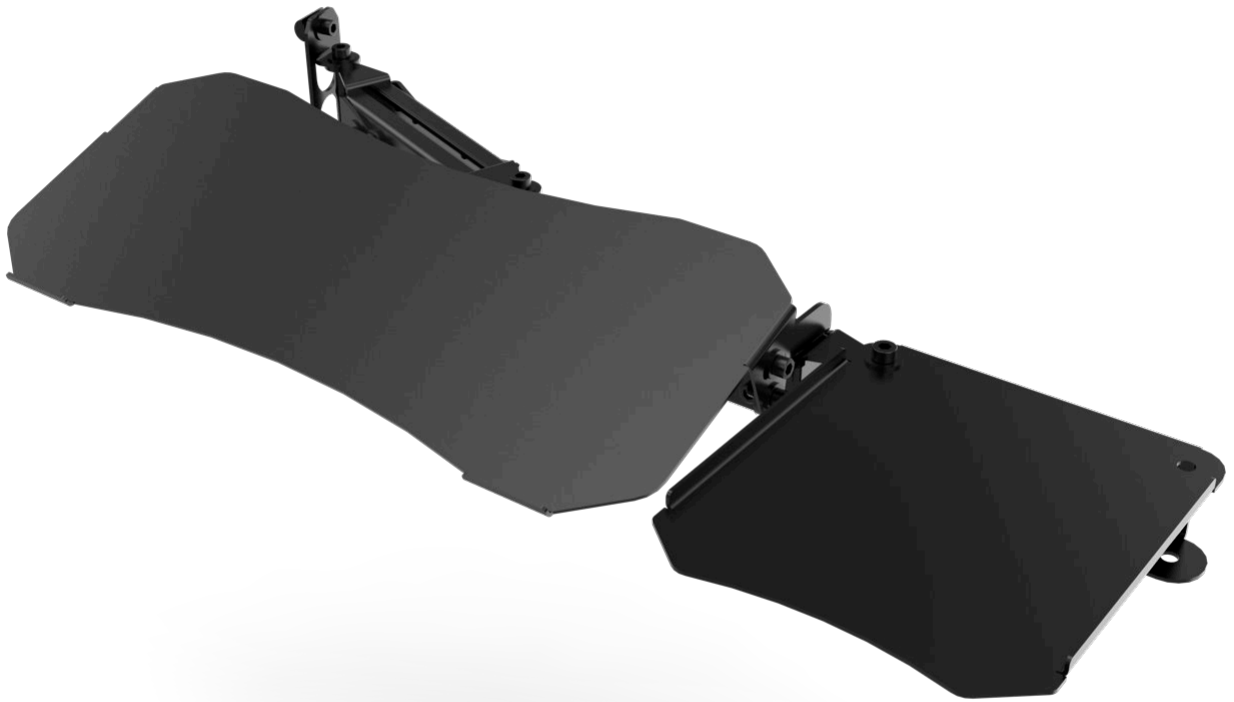

Share your build online and tag us to be featured!



@trakracer



@trakracer



@trak_racer